

JASON K MOORE, PE

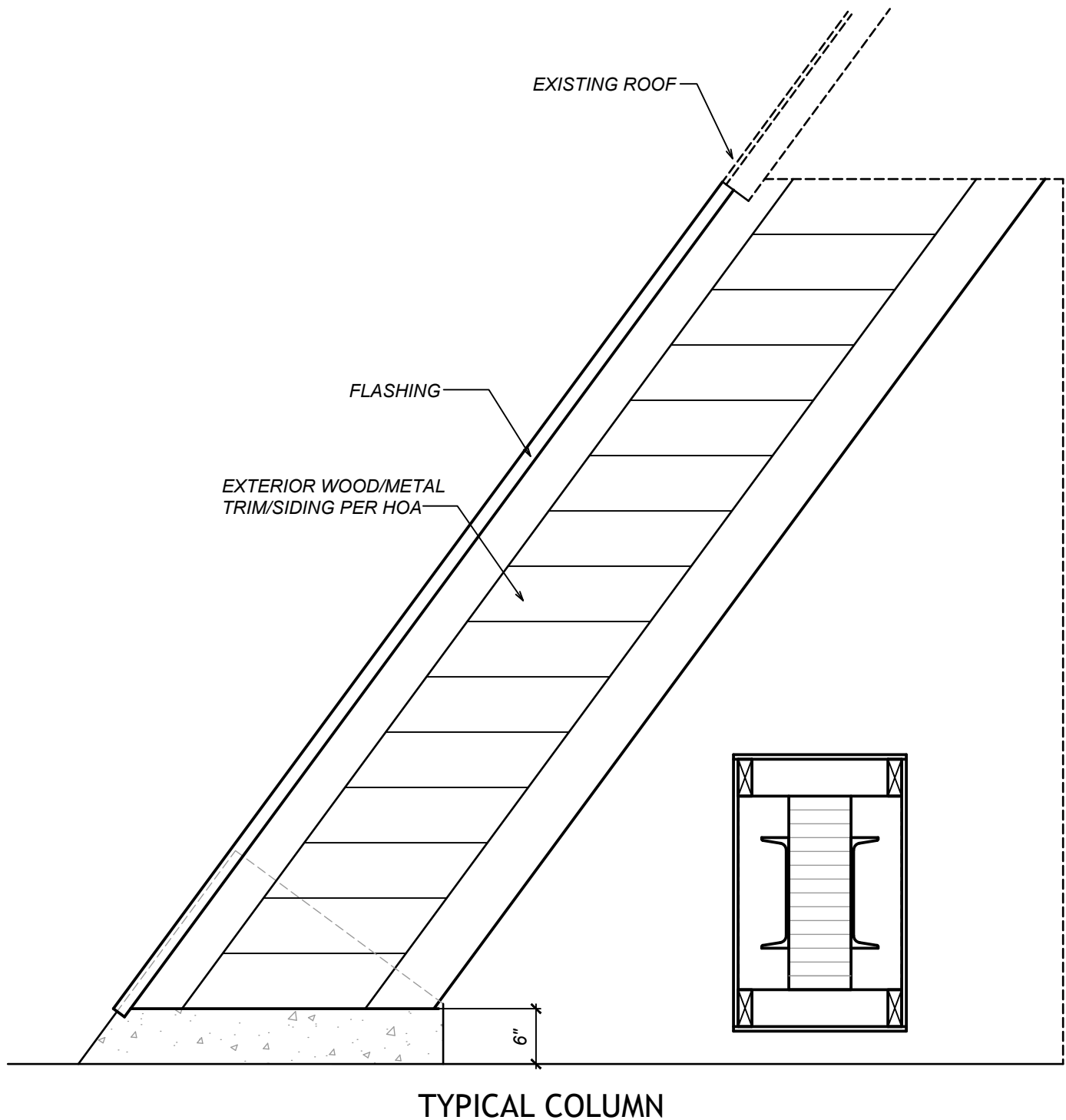

CHATEAU CHAPPERAL LODGE . TYPICAL DETAIL . 4.10.2018

PO BOX 5277 - BUENA VISTA, COLORADO 81211
PHONE: 719.239.0715 - EMAIL: JASONKMOOREPE@GMAIL.COM

JASON K MOORE, PE

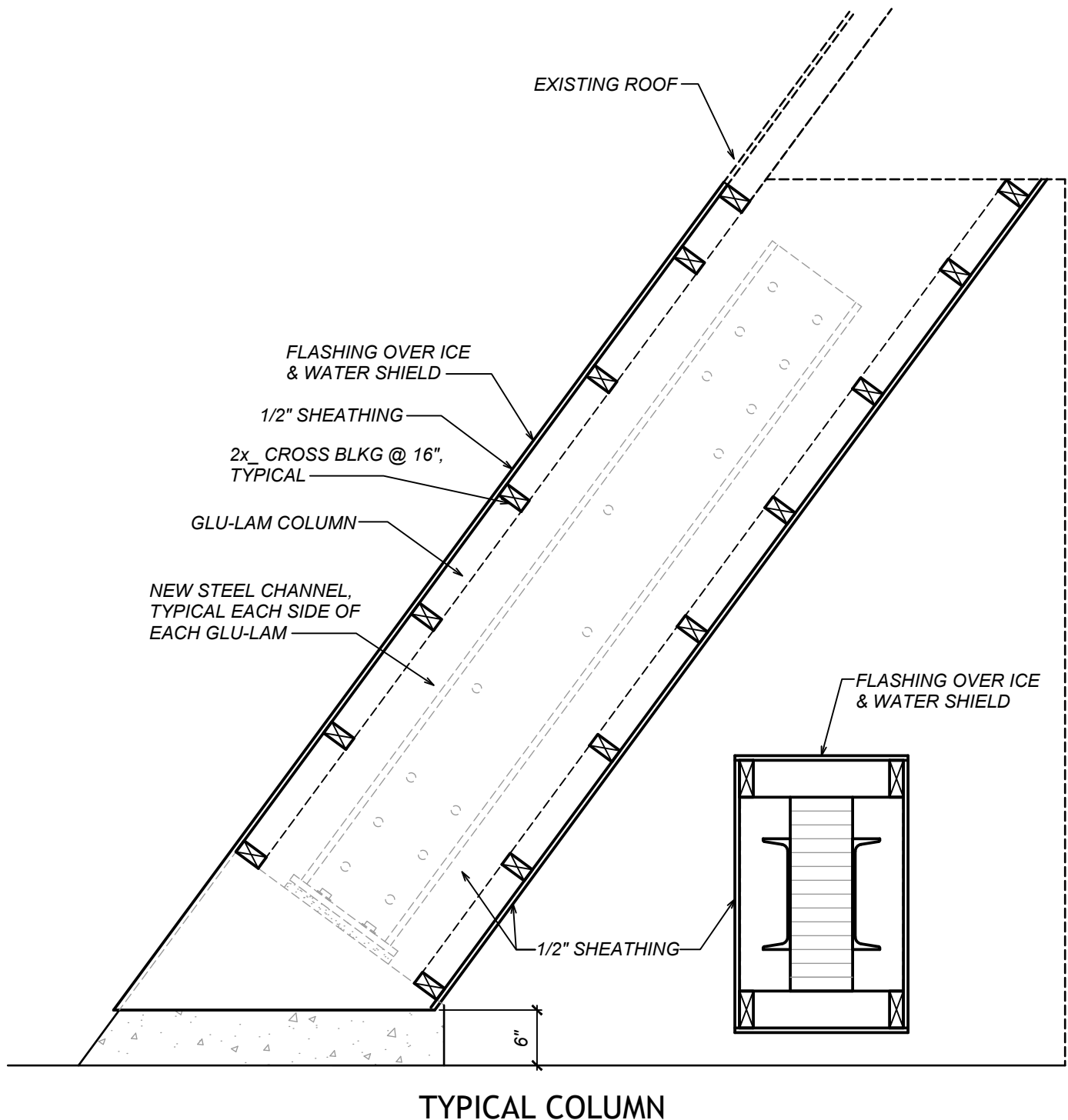

CHATEAU CHAPPERAL LODGE . TYPICAL DETAIL . 4.10.2018

PO BOX 5277 - BUENA VISTA, COLORADO 81211
PHONE: 719.239.0715 - EMAIL: JASONKMOOREPE@GMAIL.COM

JASON K MOORE, PE

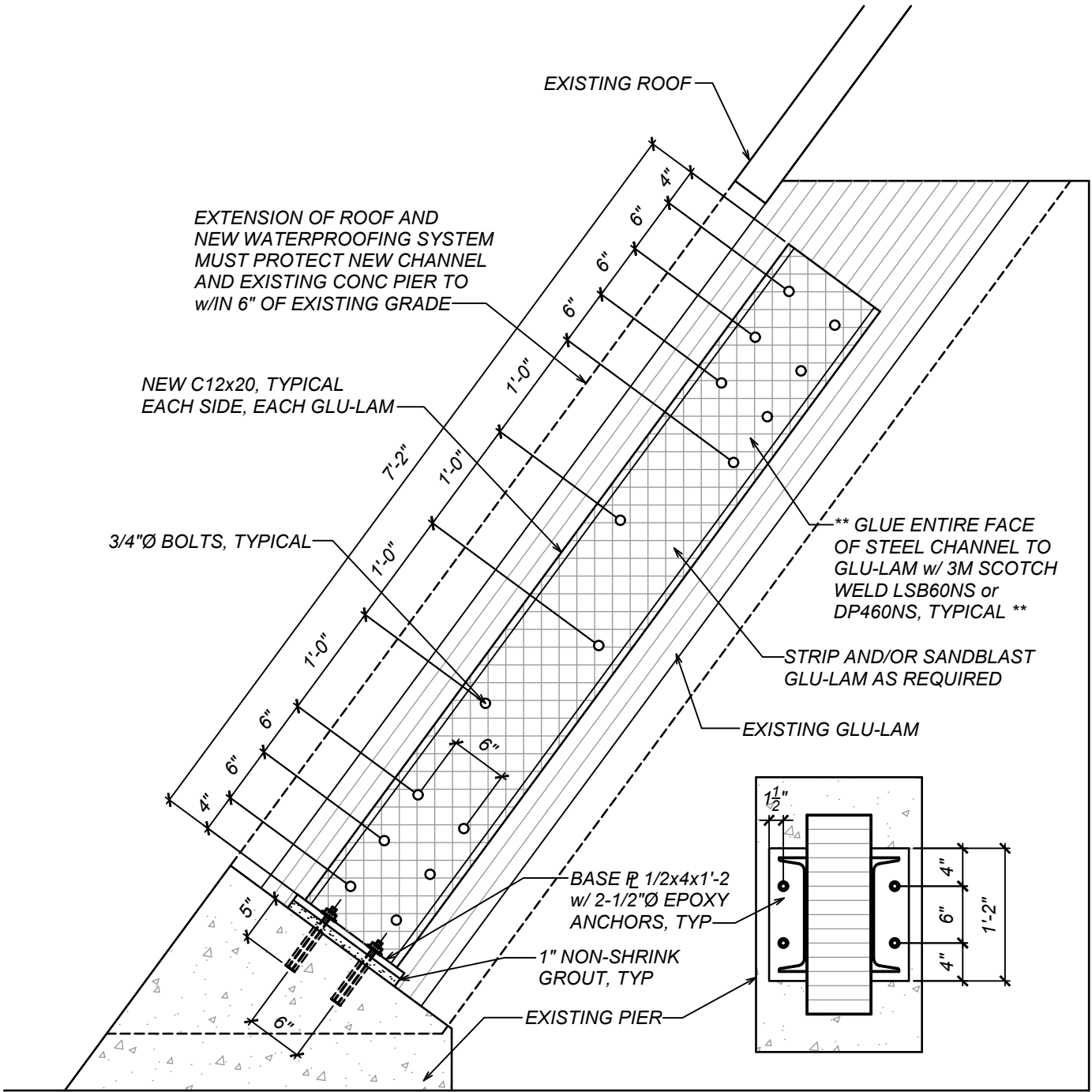

DOUBLE C12x20 DETAIL - 12 LOCATIONS

VERIFY DIMENSIONS FOR 4-GLU-LAMS AT WEST
& EAST ENTRY - 4 LOCATIONS

CHATEAU CHAPPERAL LODGE . TYPICAL DETAIL . 4.10.2018

PO BOX 5277 - BUENA VISTA, COLORADO 81211
PHONE: 719.239.0715 - EMAIL: JASONKMOOREPE@GMAIL.COM

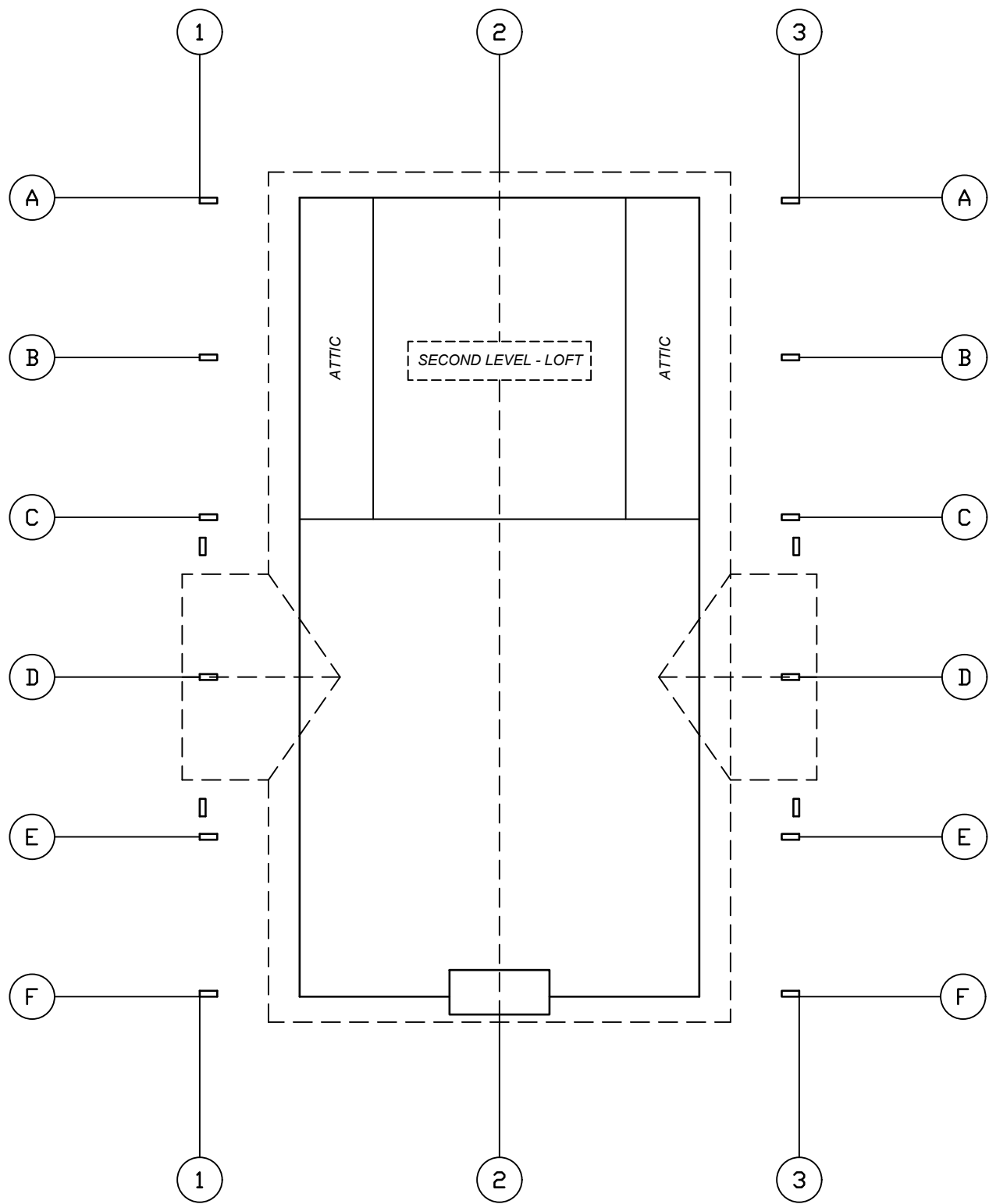

JASON K MOORE, PE

General Notes:

- 1. Construction shall be in accordance with the requirements of the 2015 "International Residential Code" except where local codes and construction documents are more restrictive*
- 2. Contractor shall verify and coordinate all dimensions. Contractor shall notify Architect and Engineer of any discrepancies and receive written clarification before proceeding with construction.*
- 3. Contractor shall contact engineer for pre construction meetings to discuss and clarify any and all revisions, changes, and modifications. All revisions, changes, and modifications shall be approved in writing prior to proceeding with construction.*
- 4. Structural plans show structural requirements only. Additional members may be required for blocking, nailers, and to meet minimum compliance with local building code requirements. Bracing, shoring, and other temporary construction may be required to achieve the final structural systems shown on the drawings.*
- 5. Contact engineer to discuss any discrepancies or to request any clarification of completed structural systems prior to construction.*
- 6. Any and all existing construction shall be verified and final dimensions coordinated with Architect prior to proceeding with construction. Existing construction types and conditions varying from conventional modern construction conforming to current codes shall be confirmed and evaluated by engineer prior to proceeding with construction. Additional structural components may be required to ensure final construction is adequate to support current design loads.*

Concrete General Notes:

- 1. Material and workmanship shall be in accordance with the requirements of "Building Code Requirements for Reinforced Concrete" (ACI 318).*
- 2. All concrete shall have a minimum compressive strength at the age of 28 days as follows:
Walls and Footings: 3000 PSI
Slabs on Grade: 4000 PSI*
- 3. All cement used in concrete shall be type I/II.*

Structural Steel General Notes:

- 1. Structural steel shall be detailed, fabricated, and erected in accordance with AISC "Specifications For Structural Steel Buildings" and "Code of Standard Practice".*
- 2. Structural steel rolled shapes, including plates and angles shall be ASTM A36. Tube shapes shall be ASTM A500 Grade B.*
- 3. All bolts, including anchor bolts shall be ASTM A307.*
- 4. All welding shall be done by a certified welder in accordance with AISC and AWS specifications and recommendations.*

CHATEAU CHAPPERAL LODGE . GENERAL NOTES 1/2 . 4.10.2018

JASON K MOORE, PE

Wood General Notes:

1. All wood framing shall conform to the "National Design Specification for Wood Construction", latest edition, recommended by the "National Forest Products Association."
2. Sawn lumber framing members shall conform to the following species and grades:
Wall studs: Hem fir or Douglas-Fir, stud grade
Horizontal plates: Douglas-Fir, #2
Headers and other framing: Douglas-Fir, #2 or better.
Beams and Posts: Douglas-Fir #1
3. All roof sheathing shall be 7/16" APA rated exposure 1 with a minimum span rating of 32/16. Plywood roof nailing shall be 8d common nails at 6" o.c. At panel edges and 12" o.c. at intermediate members unless noted otherwise on the drawings.
4. All exterior wall sheathing and interior shear wall sheathing shall be 7/16" APA rated sheathing Exposure 1 with a minimum span rating of 24/16.
5. Install exterior wall sheathing with long dimension of panel parallel to studs. Provide 2x blocking between wall studs at all horizontal panel joints. Nailing shall be 8d at 4" o.c. at panel edges and 12" o.c. at intermediate members unless noted otherwise on the drawings.
6. Joist hangers and Hurricane clips shall be Simpson Strong-Tie connectors as manufactured by the Simpson Strong-Tie corporation.
7. Framing plans show structural requirements only. Additional members may be required for blocking, nailers, and to meet minimum compliance with local building code requirements. Bracing, shoring, and other temporary construction may be required to achieve the final structural systems shown on the drawings. Contact engineer to discuss any discrepancies or to request any clarification of completed structural systems prior to proceeding with construction.
8. Maintain 6" clearance between untreated wood or and soils at finish grade.
9. Nailing, blocking, and all other construction details per Building Code.

Epoxy Adhesive:

1. Epoxy used in connections shall be a high modulus, two-component, moisture insensitive, 100 percent solids, thermosetting modified polyamide epoxy compound. Consistency shall be either paste or flowwable, depending on specific application.
2. Epoxy shall be applied in strict accordance with practices recommended by epoxy manufacturer. Surface must be clean and sound. Remove all paint, dirt, laitance, grease, curing compounds and other foreign matter by sandblasting, shot blasting, or mechanical abrasion. Remove water and dust from all surfaces with an oil-free compressed air blast immediately prior to application.

Shop Drawings:

1. Provide three (3) prints each of shop detail and erection drawings for structural steel to engineer for review prior to fabrication.

Design Loads:

Roof Loads:

Dead: 15 PSF
Snow Load: 40 PSF

Wind Load:

120 MPH Vult

CHATEAU CHAPPERAL LODGE . GENERAL NOTES 2/2 . 4.10.2018